



SCHOOL TYPE
LEARNING / SUPPORT UNIT
ROOM / SPACE
TYPE / ID

Schools for Specific Purposes
Staff Unit
Staff Room
Type 5 - SSP602.05

SCHEDULE AREA 65m²

FIXTURES	
ID	QUANTITY
BWU	1
R/F	1
MO	1
DW	1
FURNITURE	
ID	QUANTITY
B-122	1
B-21	1
B-24	1
B-29R	1
Bo-20	1
Bo-27	1
C-09	1
C-26	2
LS-832	1
M-77	1
M-91	2
S-93	32
SK-42	1
T-20	6
T-26	1

Furniture quantities are indicative and are related to the floor plan indicated. Actual furniture selection and quantities will be dependent on the approved design, specific school needs, student ages, student capabilities and their teachers.

REVISION DATE
02 MAY 2014

The information on this sheet once printed/exported is classed as an uncontrolled copy.
The currency of the information should be checked by visiting the EFSG website prior to using the information for any purposes.

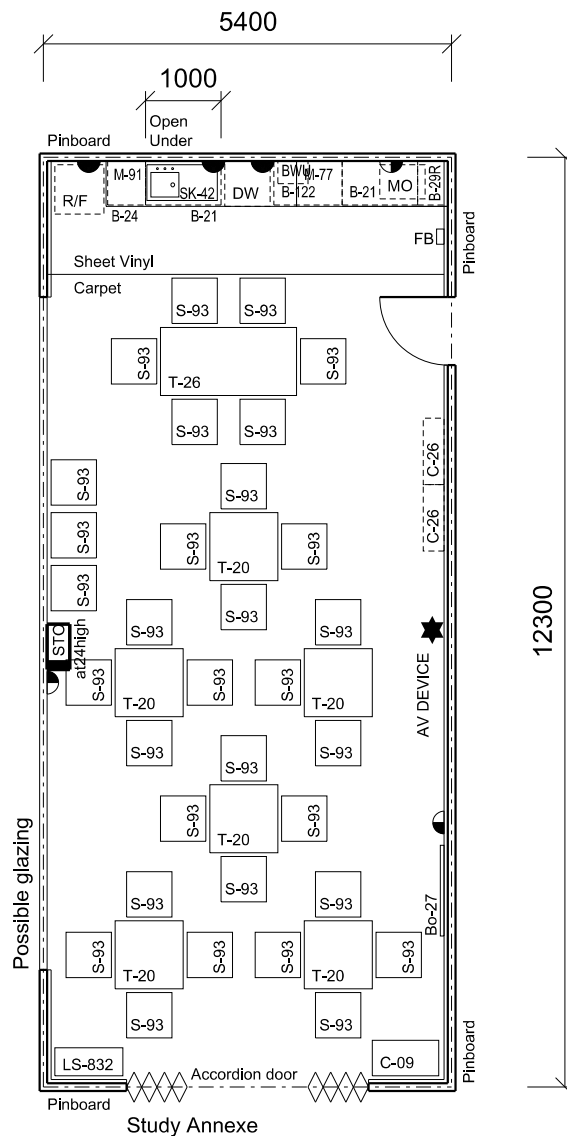

Floor Area shown 64.41 sq.m

1:100 @ A4 0 1 2 3 4m