

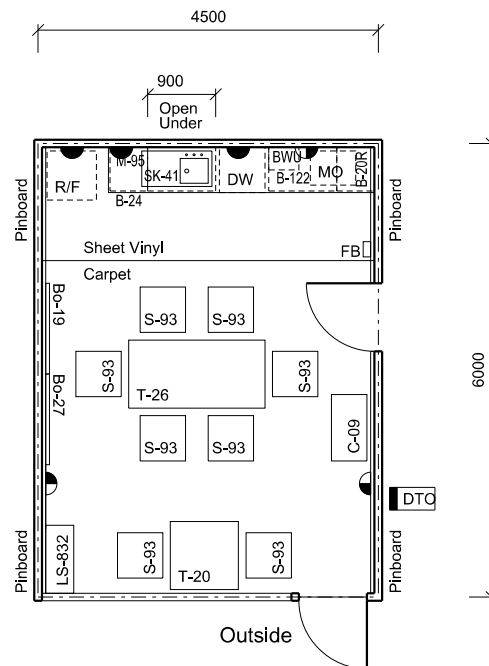

Schools for Specific Purposes
Staff Unit
Staff Room
Type 2 - SSP602.02

SCHEDULE AREA 26m²



Floor Area shown 25.96 sq.m

FIXTURES

ID	QUANTITY
BWU	1
R/F	1
MO	1
DW	1

FURNITURE

ID	QUANTITY
B-122	1
B-20R	1
B-24	1
Bo-19	1
Bo-27	1
C-09	1
LS-832	1
M-95	1
S-93	8
SK-41	1
T-20	1
T-26	1

Furniture quantities are indicative and are related to the floor plan indicated. Actual furniture selection and quantities will be dependent on the approved design, specific school needs, student ages, student capabilities and their teachers.

1:100 @ A4

REVISION DATE
19 DECEMBER 2013

The information on this sheet once printed/exported is classed as an uncontrolled copy.
The currency of the information should be checked by visiting the EFGS website prior to using the information for any purposes.