



DRAWING TITLE
SCHOOL TYPE
KEY LEARNING / SUPPORT AREA

Shelving for Pottery
Secondary
HS503 Outdoor Covered Workshop

LOCATION

HS503.03 Kiln Space
HS503.05 Pottery Store

SPECIFICATION REF

Timber Fixtures

NOTES

Guide only; do not use as a construction detail
Length may vary according to project requirements
A.S. = Adjustable
F.S. = Fixed

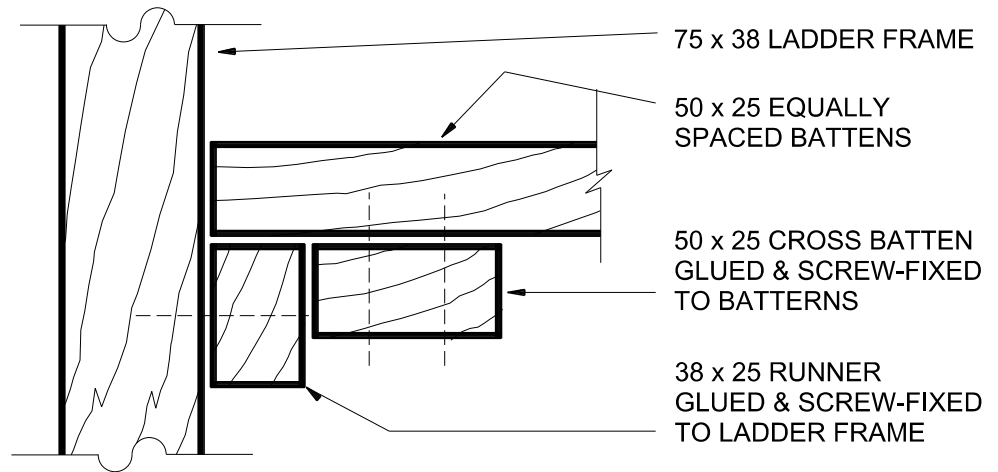

DETAIL - A

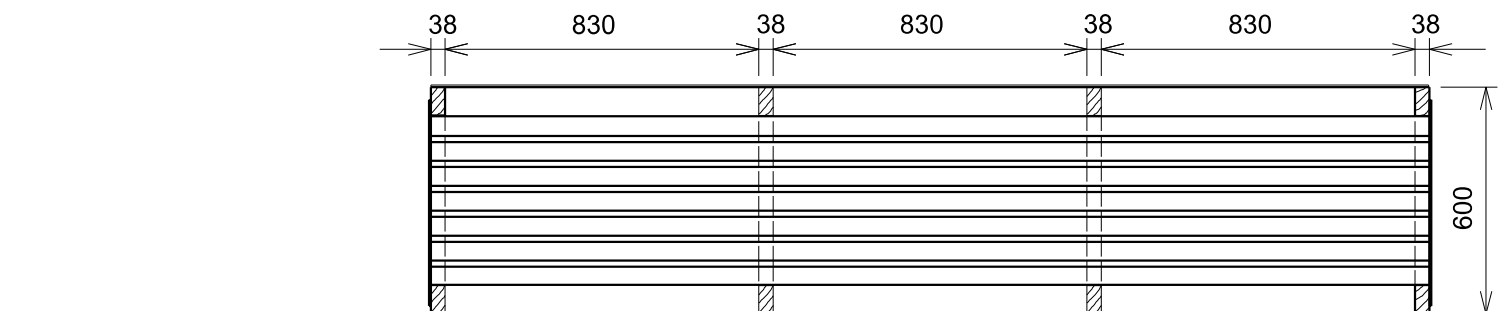
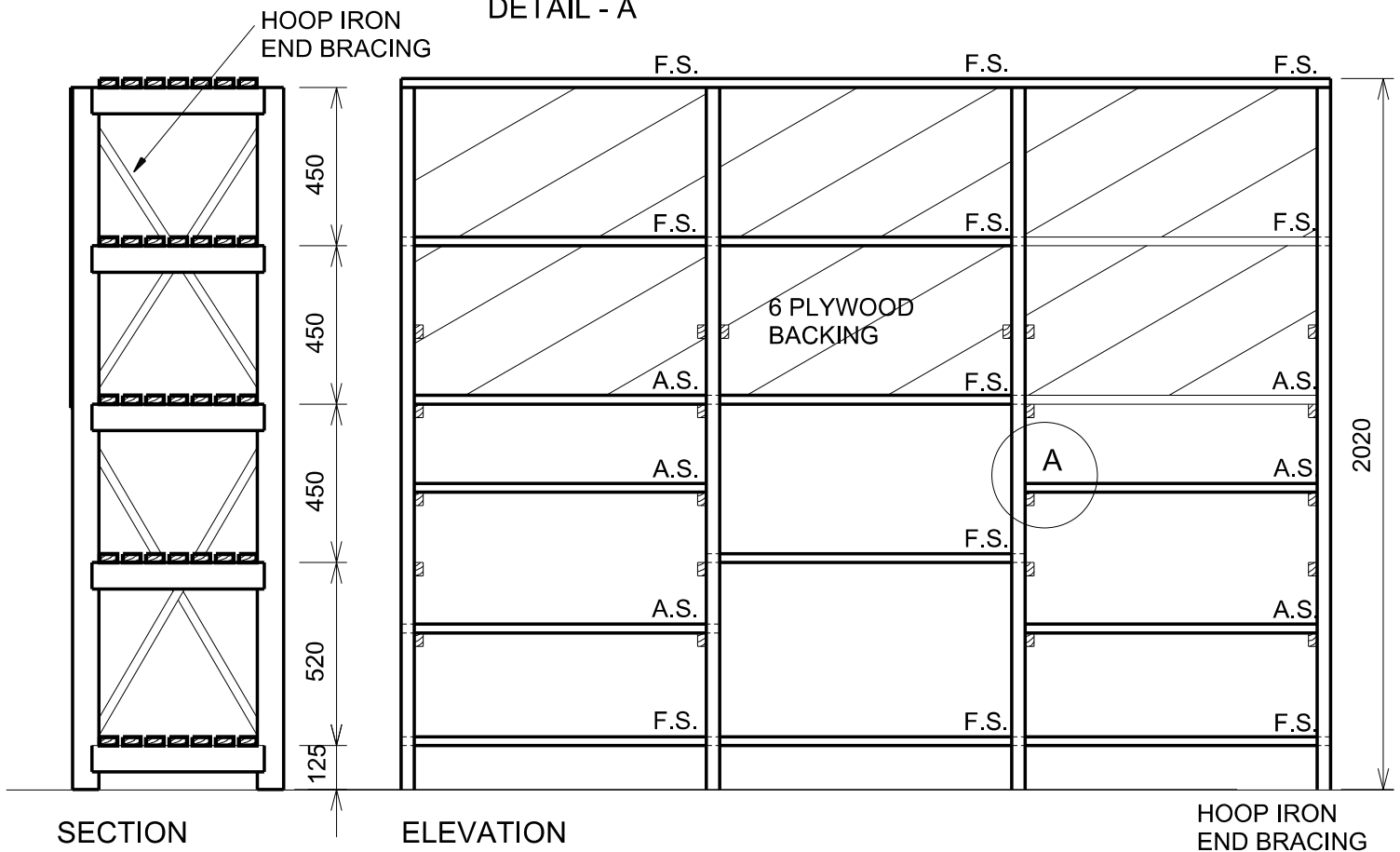

PLAN - SHELVING FOR POTTERY

NTS