



SCHOOL TYPE
KEY LEARNING / SUPPORT AREA
ROOM / SPACE
TYPE / ID

Primary
Staff Unit
Staff Room - Adjoining Annexe
Type 3 - PS602.03

SCHEDULE AREA 33m²

NOTES

1 For Core 7

FIXTURES

ID	QUANTITY
MO	1
BWU	1
R/F	1
DW	1

FURNITURE

ID	QUANTITY
B-20L	1
B-21	1
B-24	1
Bo-19	1
Bo-27	1
C-09	1
C-26	1
LS-832	1
M-93	1
S-93	12
SK-41	1
T-20	2
T-26	1

Furniture quantities are indicative and are related to the floor plan indicated. Actual furniture selection and quantities will be dependent on the approved design, specific school needs, student ages, student capabilities and their teachers.

REVISION DATE
25 OCTOBER 2013

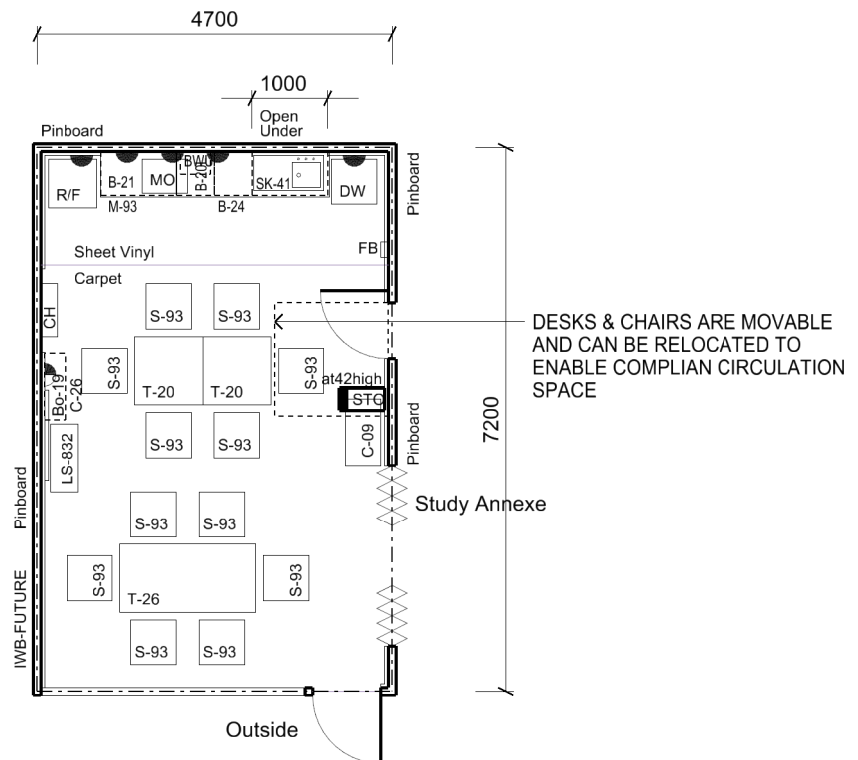

Floor Area shown 32.66 sq.m

1:100 @ A4 0 1 2 3 4m

The information on this sheet once printed/exported is classed as an uncontrolled copy.
The currency of the information should be checked by visiting the EFSG website prior to using the information for any purposes.