



SCHOOL TYPE  
KEY LEARNING / SUPPORT AREA  
ROOM / SPACE  
TYPE / ID

Primary  
Administration Unit  
Clerical / Printing / Workroom  
Type 4 - PS601.24

**SCHEDULE AREA** 60m<sup>2</sup>

## NOTES

1 For Core 21

## FIXTURES

ID	QUANTITY
SAFE	1
RECEPTION	1
COUNTER	
WORKBENCH	1
MSS400/300A	1
CCTV	1
BRACKET	

FURNITURE

ID	QUANTITY
B-33	1
B-36L	1
B-36R	2
B-53	2
C-26	1
C-29	5
D-05	2
L-04	1
LS-793	1
S-14	4
S-32	1
S-34	1
SW-206	1
SW-208	1
SW-405	1
SW-932	2
T-60	2
T-88	4
TW-243	1

Furniture quantities are indicative and are related to the floor plan indicated. Actual furniture selection and quantities will be dependent on the approved design, specific school needs, student ages, student capabilities and their teachers.

**REVISION DATE**  
28 OCTOBER 2013

The information on this sheet once printed/exported is classed as an uncontrolled copy.  
The currency of the information should be checked by visiting the EFGS website prior to using the information for any purposes.

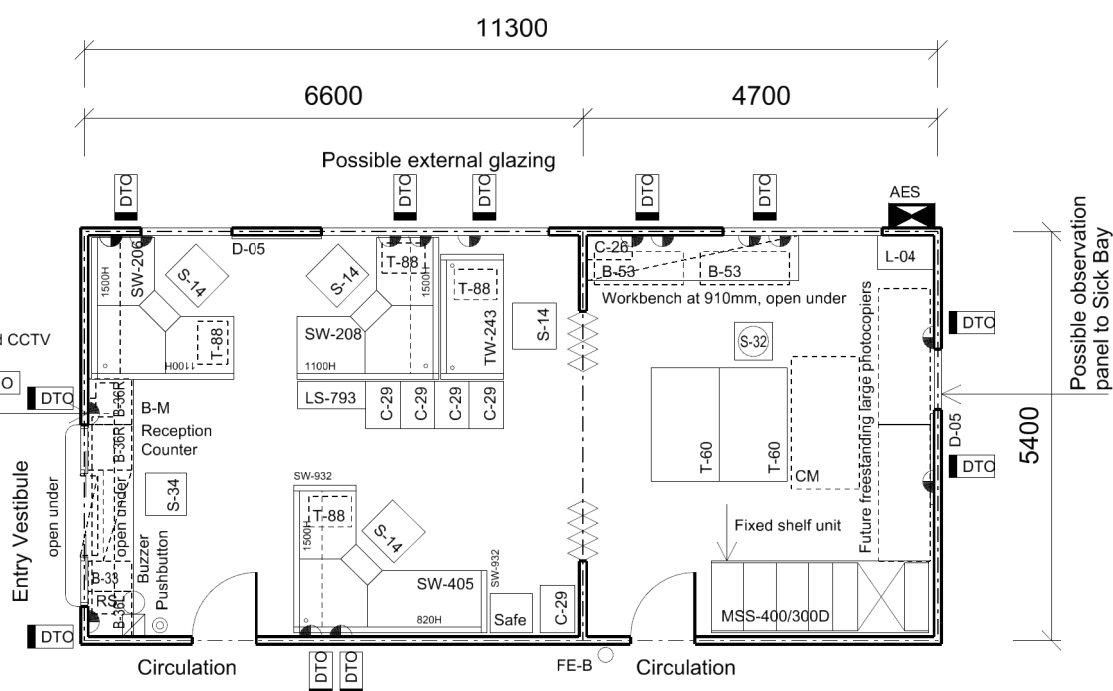

Floor Area shown 59.36 sq.m

1:100 @ A4