



SCHOOL TYPE
KEY LEARNING / SUPPORT AREA
ROOM / SPACE
TYPE / ID

Primary
Administration Unit
Clerical/Printing
Type 3 - PS601.23

SCHEDULE AREA 53m²

NOTES

1 For Core 14

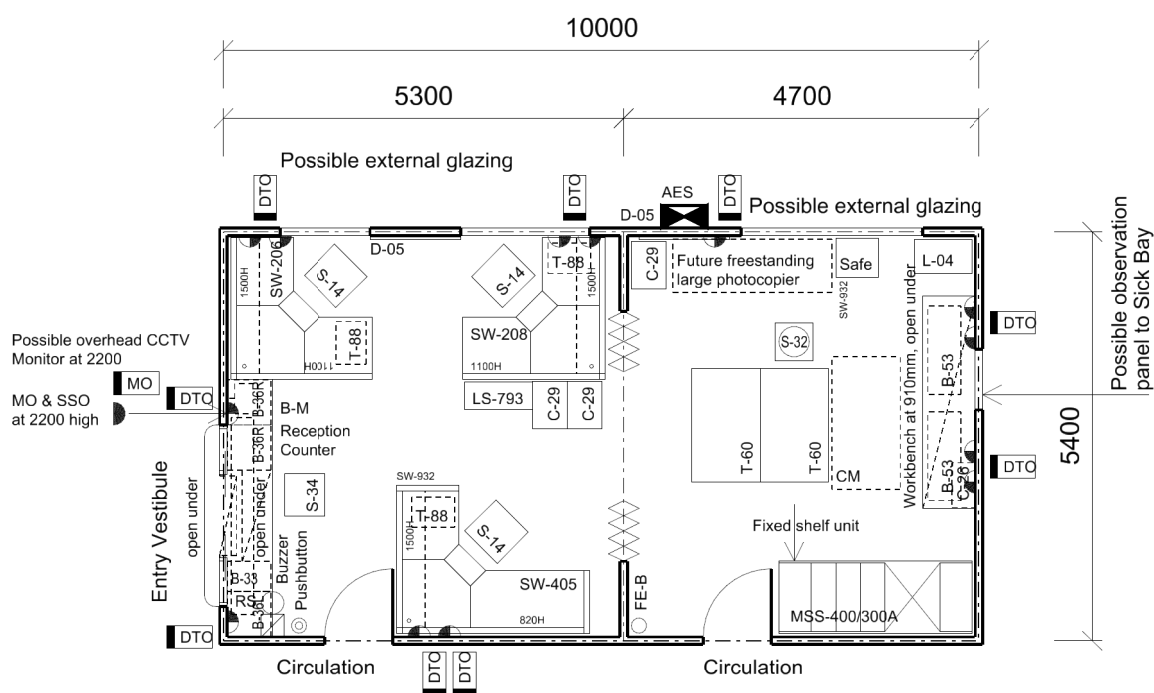

Floor Area shown 52.47 sq.m

FIXTURES

ID	QUANTITY
SAFE	1
RECEPTION COUNTER	1
WORKBENCH	1
MSS 400/ 300 A	
CCTV	1
BRACKET	

FURNITURE

ID	QUANTITY
B-33	1
B-36L	1
B-36R	2
B-53	2
C-26	1
C-29	3
D-05	2
L-04	1
LS-793	1
S-14	3
S-32	1
S-34	1
SW-206	1*
SW-208	1*
SW-405	1*
SW-932	2
T-60	2
T-88	3

Furniture quantities are indicative and are related to the floor plan indicated. Actual furniture selection and quantities will be dependent on the approved design, specific school needs, student ages, student capabilities and their teachers.

1:100 @ A4 

REVISION DATE
28 OCTOBER 2013

The information on this sheet once printed/exported is classed as an uncontrolled copy.
The currency of the information should be checked by visiting the EFGS website prior to using the information for any purposes.