

**SCHOOL TYPE**
KEY LEARNING / SUPPORT AREA
ROOM / SPACE
TYPE / IDPrimary
Communal Hall Unit
Communal Hall - Large
Type 2 - PS503.02**SCHEDULE AREA** 190m²**NOTES**

- 1 For Core 14
- 2 Double handrails required
Handrails to contrast with
background / wall

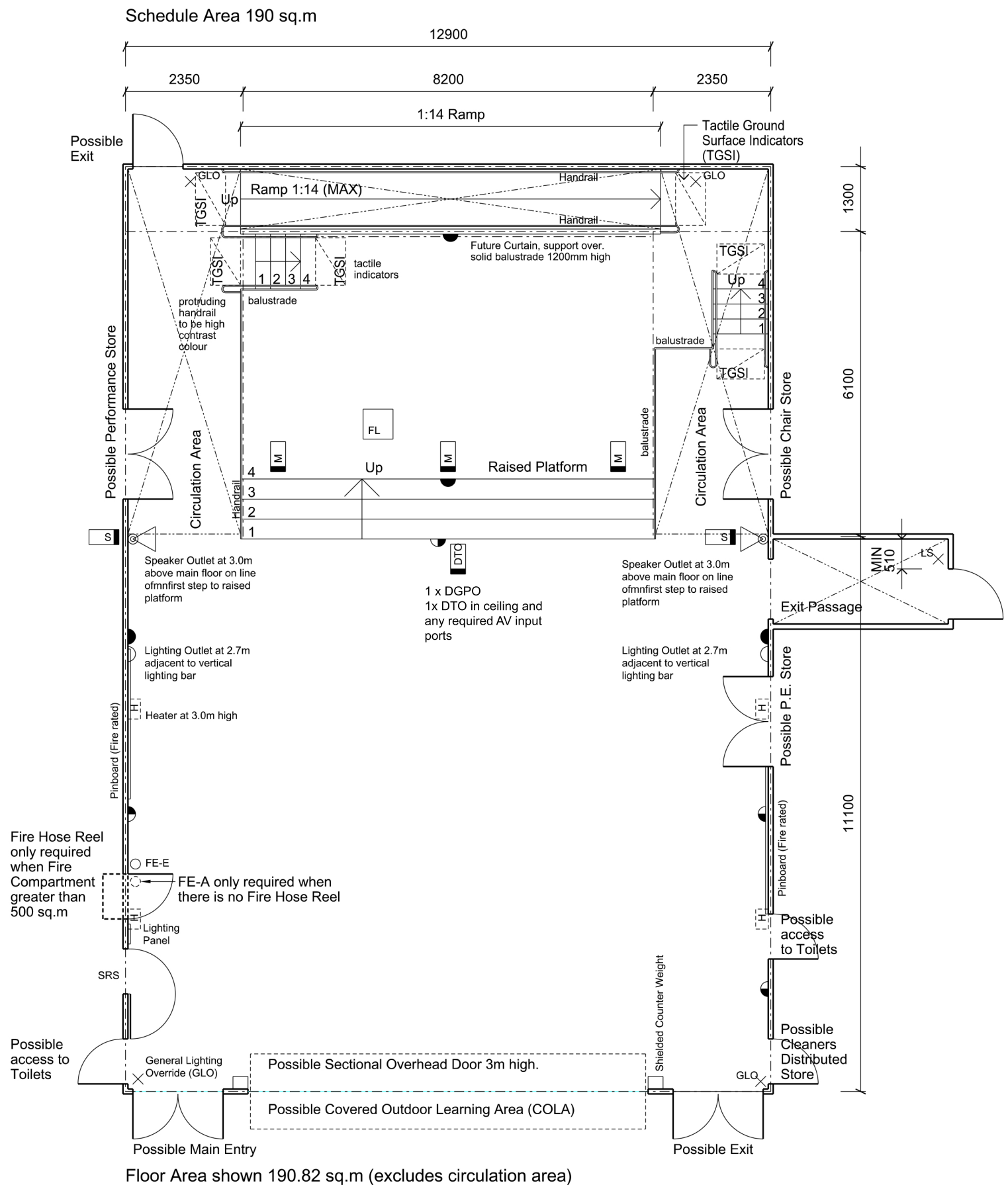

FIXTURES	
ID	QUANTITY
VERTICAL	2
LIGHT BARS	
FLOOR LECTURN	1

Furniture quantities are indicative and are related to the floor plan indicated. Actual furniture selection and quantities will be dependent on the approved design, specific school needs, student ages, student capabilities and their teachers.

DTO = Double Telecommunication Outlet
DGPO = Double General Purpose Outlet

1:100 @ A3 0 1 2 3 4m

REVISION DATE
7 NOVEMBER 2013

The information on this sheet once printed/exported is classed as an uncontrolled copy.
The currency of the information should be checked by visiting the EFSG website prior to using the information for any purposes.