



SCHOOL TYPE
KEY LEARNING / SUPPORT AREA
ROOM / SPACE
TYPE / ID

Primary
Special Programs Unit
Special Programs Room
Type 1 - PS502.01

SCHEDULE AREA 32m²

NOTES

- At least one GPO to be between 900mm and 1100mm above floor

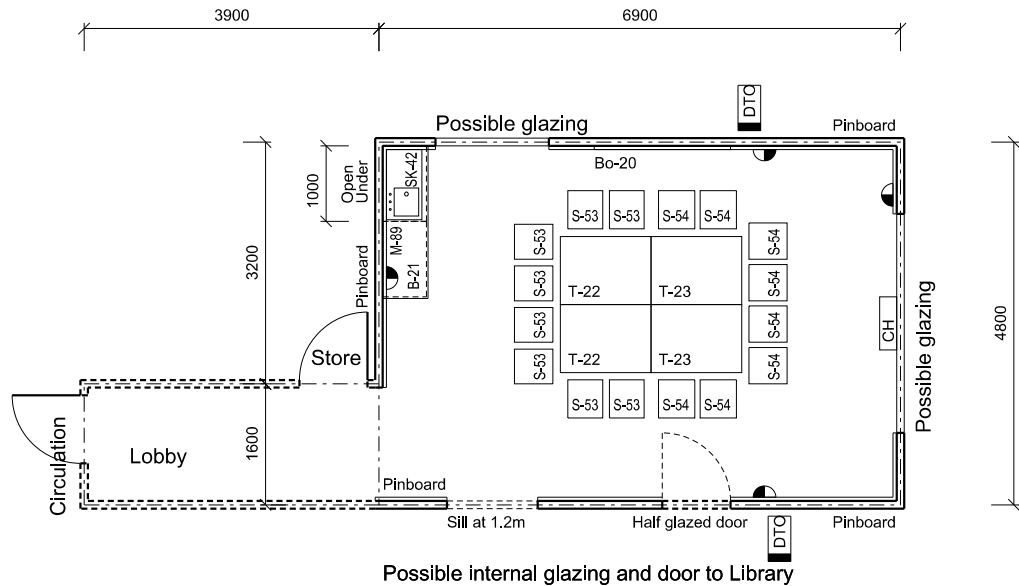

Floor Area shown 31.96 sq.m

FURNITURE

ID	QUANTITY
B-21	1
Bo-20	1
M-89	1
S-53	8
S-54	8
SK-42	1
T-22	2
T-23	2

Furniture quantities are indicative and are related to the floor plan indicated. Actual furniture selection and quantities will be dependent on the approved design, specific school needs, student ages, student capabilities and their teachers.

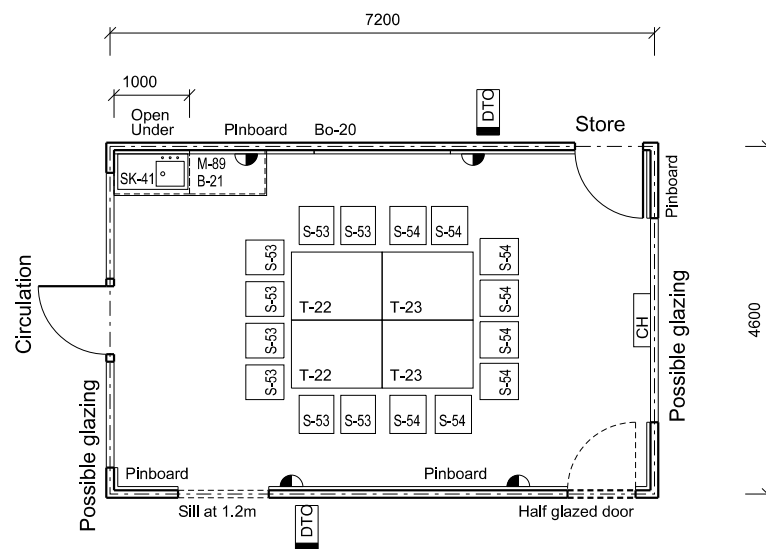

Floor Area shown 31.95 sq.m

1:100 @ A4 0 1 2 3 4m

REVISION DATE
7 NOVEMBER 2013

The information on this sheet once printed/exported is classed as an uncontrolled copy.
The currency of the information should be checked by visiting the EFSG website prior to using the information for any purposes.