



SCHOOL TYPE
KEY LEARNING / SUPPORT AREA
ROOM / SPACE
TYPE / ID

Primary
 Special Education Learning Unit (IO/IS/P)
 Personal Effects Storage - IS/P
 PS430.42

SCHEDULE AREA 3m²

NOTES

- 1 M-14, fixed at 1.2m from the top of the top horizontal bar to walkway surface.
- 2 M-15, 2 rows fixed at 450mm, and 900mm, stagger rows of hooks by 175mm.

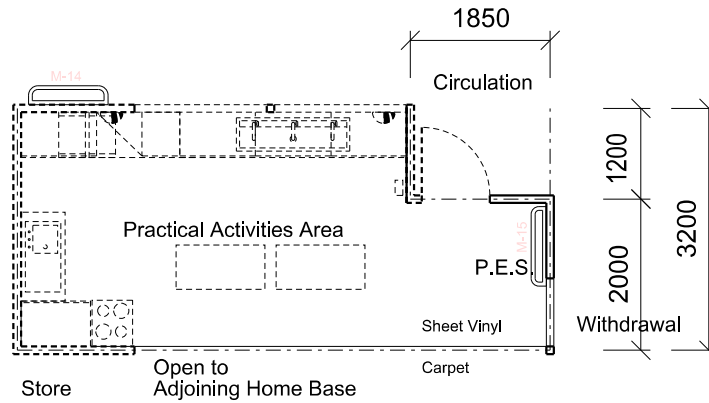

Floor Area shown 3.1 sq.m

FURNITURE

ID	QUANTITY
M-14	1*
M-15	2*

* To be selected according to the user group characteristics. Selections to be confirmed by project control group

Furniture quantities are indicative and are related to the floor plan indicated. Actual furniture selection and quantities will be dependent on the approved design, specific school needs, student ages, student capabilities and their teachers.

1:100 @ A4 0 1 2 3 4m

REVISION DATE
 7 NOVEMBER 2013

The information on this sheet once printed/exported is classed as an uncontrolled copy.
 The currency of the information should be checked by visiting the EFSG website prior to using the information for any purposes.