

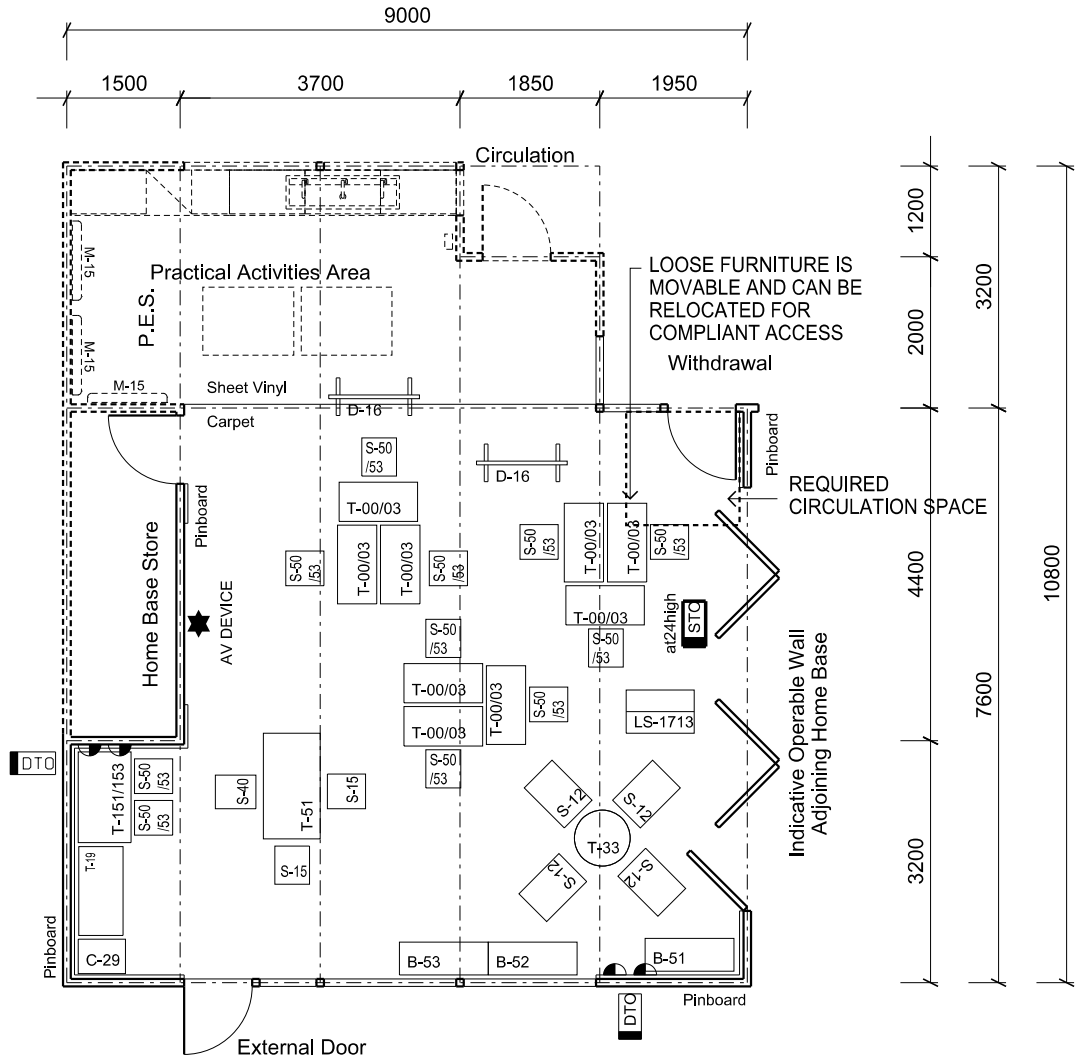

SCHOOL TYPE  
KEARNING PS  
ROOM / SPACE  
TYPE / ID

Primary  
Special Education Unit - IO/IS/P  
Home Base with Practical Activities Area - IO  
PS430.01

SCHEDULE AREA 60m<sup>2</sup>



FURNITURE  
ID QUANTITY

B-51	1
B-52	1
B-53	1
Bo-25	1
C-29	1
D-16	2
LS-1713	1
S-12	4
S-15	2
S-40	1
S-50	*
S-51	*
S-52	*
S-53	*
T-00	*
T-01	*
T-02	*
T-03	*
T-151	*
T-152	*
T-153	*
T-19	1
T-33	1
T-51	*

Floor Area shown 79.92 q.m  
(including P.A.A. 17 sq.m & P.E.S. 3 sq.m)

\* To be selected according to the user group characteristics. Selections to be confirmed by project control group

Furniture quantities are indicative and are related to the floor plan indicated. Actual furniture selection and quantities will be dependent on the approved design, specific school needs, student ages, student capabilities and their teachers.

REVISION DATE  
24 OCTOBER 2013

The information on this sheet once printed/exported is classed as an uncontrolled copy.  
The currency of the information should be checked by visiting the EFSG website prior to using the information for any purposes.

1:100 @ A4 0 1 2 3 4m